

TYPE G TRUNNION MOUNT LED AREA LIGHTING

INSTALLATION INSTRUCTION GUIDE

⚠ IMPORTANT SAFEGUARDS ⚠

Read these instructions completely and carefully before proceeding with installation or service maintenance of this product:

- To avoid the possibility of electric shock, turn off power supply before installation/servicing.
- Before closing cover of fixture, make sure all wires are inside fixture housing to avoid pinching wires.
- Fixture must be installed in accordance with NEC or local electrical codes by qualified technician.
- For protection, technician should always wear protective goggles and gloves during the installation and maintenance.
- SolarMax LED is not responsible for any damages caused by parts/components that are not supplied by SolarMax LED.

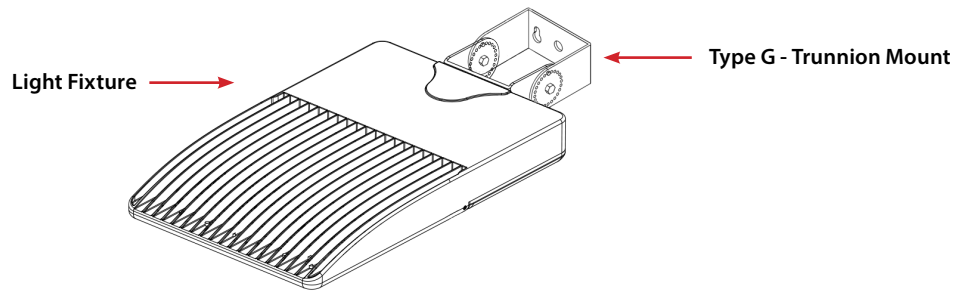

Included Items in Box

Items included may vary based on your order



(1 PC) Fixture



(1 PC) Trunnion Mount



A1

(2 PC) M8*25mm Hex Bolts
(2 PC) Springs, Washers, and Nuts
Included



A2

(2 PC) M4*20mm Hex Bolts
(2 PC) Springs, Washers, and Nuts
Included



A3

(4 PC) M8*20mm Hex Sockets
Included

1

STEP 1

Use the bolt pattern to drill hole(s) into the wall or ceiling where the fixture will be mounted. Electrician shall provide the screws per the jobsite condition.

Tool needed:

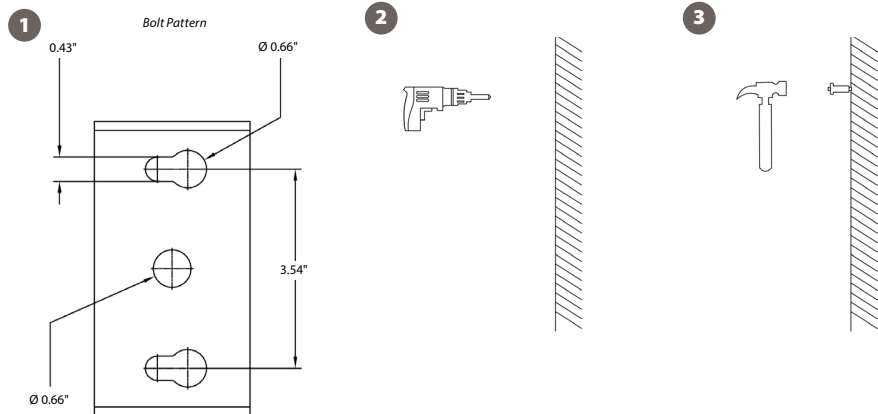

TYPE G TRUNNION MOUNT LED AREA LIGHTING

INSTALLATION INSTRUCTION GUIDE

2

STEP 2

If the bracket is attached to luminaire, skip ahead to Step 3. Attach the luminaire bracket to the light fixture using the (4) four A3 sockets, torque of 8.3 Nm (6.2 ft-lbs). Then secure the mounting bracket to the luminaire bracket with the (2) two A1 bolts, torque of 8.3 Nm (6.2 ft-lbs).

Tools needed:



Allen Wrench



Wrench

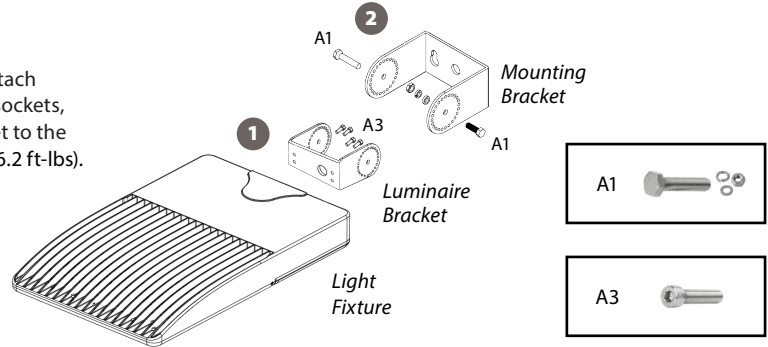

3

STEP 3

Tilt the fixture to desired angle (reference to photometrics design if available). Secure with the (2) two A2 bolts, torque of 0.8 Nm (0.6 ft-lbs).

Tool needed:



Wrench

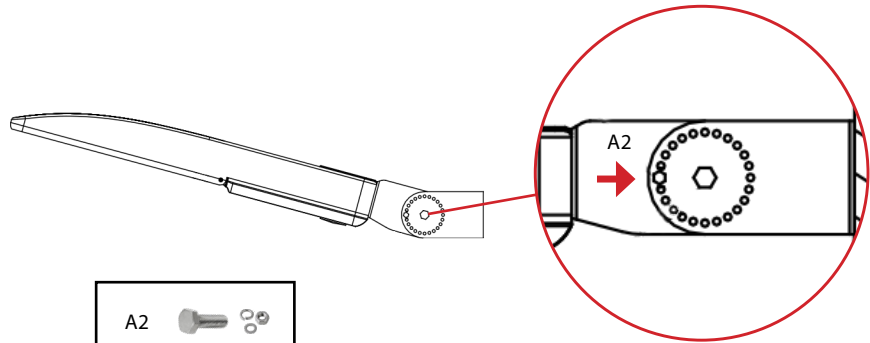

4

STEP 4

▲ To avoid possibility of electric shock, turn off power before installation.

Mount the trunnion bracket as needed. Pull the wires through from the wall or ceiling to the light fixture. Connect luminaire wires with the power source.

FIXTURE		POWER SOURCE
	Black/Brown	Line
	Blue/White	Neutral
	Green/Yellow Green	Ground
	(Optional) Blue/Purple	DIM+
	(Optional) White/Gray	DIM-

