



LED SPORTS LIGHT

INS SERIES



www.solarmaxled.com
led@solarmaxtech.com
T: 951-300-0788 ■ F: 909-595-7388
3080 12th St., Riverside, CA 92507

© SolarMax LED, Inc. 2022. All rights reserved.
Spec Sheet is subject to change without notice.
Rev. date: 2024-01-11

Project Name:

Project Number:

Note:

Date:

INS SERIES LED SPORTS LIGHTING

315 WINS - 720 WINS

1000W - 2000W MH EQUIVALENT

Project Name:

Date:

Project Number:

Note:

Features

APPLICATION

Sports Fields: Baseball, Softball,
Football, Track & Field
Flood Light applications

OPTICS

CCT 3000K, 4000K, 5000K
3 distributions: Narrow, Medium, and Wide

HOUSING

Die-cast aluminium alloy
IP 66 rating

OPERATIONAL TEMPERATURE

-40°F to +122°F

ELECTRICAL

120-277V, and 277-480V available
1-10V dimmable
Standard 20KV Surge Protection Device
Power Factor > 90%
THD < 20%
LED lifetime up to L85/100,000
hours at 25°C ambient

CONTROL OPTIONS

Wireless Control System: on/off
switching, dimming, power metering,
light scheduling, status monitoring

WARRANTY

Standard 5-year warranty
Optional 7 or 10-year warranty

CERTIFICATION



Product Dimensions

INS-A*

315W, 380W & 460W-720W

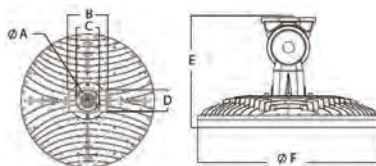

*No driver

INS-B**

315W & 380W

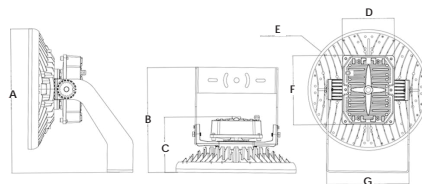

460W-720W

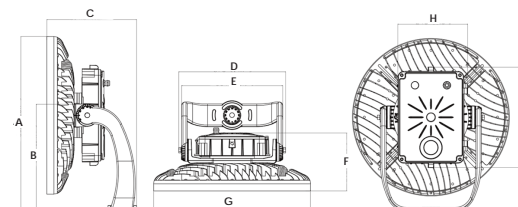

**With Driver

	315W & 380W	460W-720W
A	2.9"	
B	6.5"	
C	3.6"	
D	3.5"	
E	13.4"	13.2"
F	18.3"	21.6"
Packaging	21.3" L x 21.3" W x 16.3" H	25.2" L x 25.2" W x 17.1" H
Net Weight	22.7 lbs	35.5 lbs
Gross Weight	29.3 lbs	43.4 lbs
EPA	2.2 ft ² (front) 1.25 ft ² (side)	3.07 ft ² (front) 1.43 ft ² (side)

	315W & 380W	460W-720W
A	22"	23.7"
B	16"	14.4"
C	8.4"	12.4"
D	8"	14.8"
E	18.4"	13.9"
F	10.6"	8"
G	12.6"	21.7"
H	n/a	9.6"
I	n/a	13.8"
Packaging	21.3" L x 21.3" W x 16.1" H	25.2" L x 25.2" W x 17.1" H
Net Weight	36.4 lbs	51.1 lbs
Gross Weight	43.0 lbs	59.1 lbs
EPA	2.2 ft ² (front) 1.25 ft ² (side)	3.07 ft ² (front) 1.43 ft ² (side)

Accessory Options

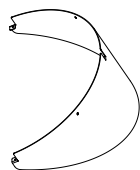

Visor

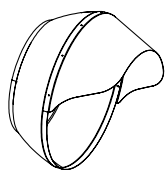

Enhanced Visor

INS SERIES LED SPORTS LIGHTING

Project Name:

315 WiNS - 720 WiNS 1000W - 2000W MH EQUIVALENT

Date:

Project Number:

Note:

Ordering Information

EXAMPLE: 315WiNS-NV-L5-00-3070-15D-A-BK-V-WC



A	B	C	D	E
Watts	Voltage	LED Chips	Type of Sensor	CCT & CRI
315WiNS 315W 380WiNS 380W 460WiNS 460W 580WiNS 580W 720WiNS 720W	NV 100-277V HV 277-480V	L5	00 Without Sensor PH Photocell	3070 3000K 70 CRI 4070 4000K 70 CRI 5070 5000K 70 CRI 3080 3000K 80 CRI 4080 4000K 80 CRI 5080 5000K 80 CRI

F	G	H	I	J
Distribution	Mount	Housing	Accessory	Control
15D Narrow (NEMA 3X3) 30D Medium (NEMA 4X4) 60D Wide (NEMA 5X5)	A Adjustable Bolt B Arch Yoke - Integrated Driver C Arch Yoke - Remote Driver D Yoke Mount DSF Slipfitter	BK Black SL Gray	V Visor EV Enhanced Visor	WC Wireless Control System

Technical Specifications

	Model	Watts	Equivalence	Lumen Output		
				3000K	4000K	5000K
SIZE 1	315WiNS	300W	1,000W MH	46,948 lm	49,500 lm	51,030 lm
	380WiNS	380W	1,100W MH	55,936 lm	58,976 lm	60,800 lm
SIZE 2	460WiNS	460W	1,200W MH	69,828 lm	73,623 lm	75,900 lm
	580WiNS	580W	1,500W MH	88,044 lm	92,829 lm	95,700 lm
	720WiNS	720W	2,000W MH	103,334 lm	108,950 lm	112,320 lm

Mounting



INS-A
Adjustable Bolt



INS-B
Arch Yoke
Integrated Driver



INS-C
Arch Yoke
Remote Driver



INS-D
Yoke Mount



INS-DSF
Slipfitter